

**Licensing Act 2003  
Schedule 12  
Part A**

Regulation 33,34

**Premises Licence**

Premises Licence Number

14/01281/LAPRE

**Part 1 – Premises Details**

**Postal address of premises, or if none, ordnance survey map reference or description, including Post Town, Post Code**

Woody Grill  
152 - 154 High Street  
Watford  
WD17 2EN

**Telephone number**

**Where the licence is time limited the dates**

From 20 November 2014

**Licensable activities authorised by the licence and the times the licence authorises the carrying out of licensable activities**

Late night refreshment	Monday to Saturday	23:00 – 02:00
	Sunday	23:00 – 01:00
Late night refreshment	New Year's Eve	23:00 – 05:00 next day
Recorded music		24 hours a day

**The opening hours of the premises**

Monday to Saturday	11:00 – 02:00
Sunday	11:00 – 01:00

**Where the licence authorises supplies of alcohol whether these are on and / or off supplies**

Not applicable

**Part 2**

**Name, (registered) address, telephone number and email (where relevant) of holder of premises licence**

Mr Cengiz Erpolat  
152-154 High Street  
Watford  
WD17 2EN

**Registered number of holder, for example company number, charity number (where applicable)**

Not applicable

**Name, address and telephone number of designated premises supervisor where the premises licence authorises the supply of alcohol**

Not applicable

**Personal licence number and issuing authority of personal licence held by designated premises supervisor where the premises licence authorises for the supply of alcohol**

Personal Licence Number: Not applicable  
Licensing Authority: Not applicable

DRAFT

**Annex 1 – Mandatory conditions**

DRAFT

## **Annex 2 – Conditions consistent with the Operating Schedule**

1. Unless otherwise specified on this licence no regulated entertainment shall take place at the premises with the exception of pre-booked private events limited to the provision of music and dancing for pre-invited guests.

### **The following conditions are considered by officers to be consistent with the Operating Schedule submitted with this application, reference 14/01281/LAPRE:**

2. All staff are to receive induction training in the promotion of the licensing objectives, and refresher training at prescribed intervals. Such training records are to be maintained and made available upon reasonable request to officers of the licensing authority, or other authorised officers.
3. No customers shall be permitted to remove from the premises any foodstuff for consumption or disposal outside of the premises after 1am (the following morning) on Mondays to Saturdays, and after Midnight on Sundays.
4. Notices shall be prominently displayed at all exits requesting patrons to respect the needs of local residents and leave the area quietly.
5. A bin shall be provided for public use within the public area of the premises.
6. A CCTV system shall be installed and maintained within the premises. The CCTV system shall continually record whilst the premises are open for licensable activities and when members of the public are on the premises. All recordings shall be stored for a minimum period of 31 days with date and time stamping.

### **Annex 3 – Conditions attached after a hearing by the licensing authority**

**The following condition has been proposed in response to representations regarding this application. The inclusion of this condition does not restrict the Sub-Committee's power to attach conditions from the licensing authority's pool of conditions (amended or otherwise) or to compose their own conditions if they consider that they are appropriate, proportionate, justifiable, and within the applicant's power to comply with.**

1. There shall be no new admittance to the premises on Mondays to Saturdays after 1am (the following morning) until the premises closes to the public, or after Midnight on Sundays until the premises closes to the public.

DRAFT

Annex 4 – Plans

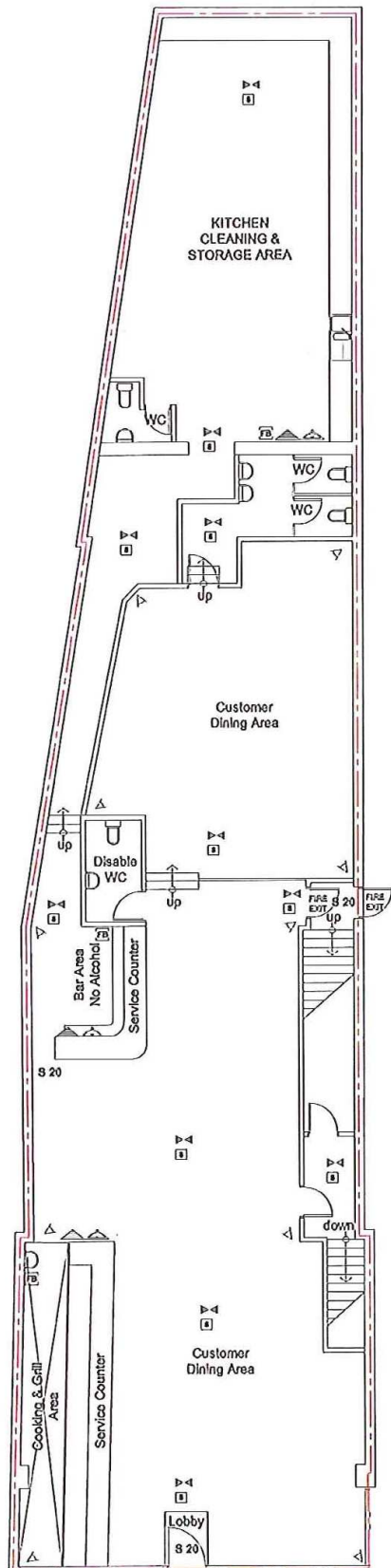

**LEGEND**

- WC AREA
- BAR AREA
- AMBIT OF LICENSED PREMISES
- SAFETY LIGHTS
- SMOKE DETECTOR
- CARBON DIOXIDE FIRE EXTINGUISHER
- 9 L.T. WATER FIRE EXTINGUISHER
- FIRE ESCAPE KEEP CLEAR
- CCTV
- INTERNALLY ILLUMINATED FIRE ESCAPE SIGN (BS 5266)
- FIRE BLANKET
- FAN GIUs
- FIRE ALARM BELL
- FIRE DOOR
- FIRE SWITCH PANEL

GROUND FLOOR PREMISES PLAN



<p><i>Design &amp; Build Ltd</i></p> <p>ARCHITECTURAL &amp; ENGINEERING DESIGN</p> <p>2 CHEFFSIDE, NORTH CIRCULAR ROAD</p> <p>LONDON, N13 5ED</p> <p>T: 0772 333 1831, 020 3213 0192</p> <p>e-mail: <a href="mailto:info@designandbuild.co.uk">info@designandbuild.co.uk</a></p> <p><a href="http://www.dbbgroup.co.uk">www.dbbgroup.co.uk</a></p>	<p>PROJECT : Premises Licence Application</p> <p>DRAWING TITLE: Proposed Ground Floor Plan</p> <p>PROJECT ADDRESS : 152-154 High Street</p> <p style="text-align: center;">Hertford, WD17 2EN</p> <p>SCALE : 1:100 @ A3      DATE : Sep/2014</p> <p>PROJECT No : CE14-01</p>
--	--